



RAS Series Stainless Steel Mini Cylinder

Ordering Code

R	—	A	—	S	—		—	40	—	50	—	Z	—	
Type R: Round barrel cylinder mini type				S: Stainless steel barrel		Back Cover Type Blank: Swiveling tail U: Flat tail CM: Round tail		Cylinder Bore 16mm~40mm		Stroke 0~1000mm		Magnet Code Blank: Without Magnet Z: With Magnet		Mounting type Blank: Basic type RLB type: Foot Mounting RFA: Flange Mounting RSDB: Trunnion bracket Mounting
		A: Standard double acting type D: Double-shaft type J: Double-shaft, adjustable stroke type SA: Single acting spring extend SB: Single acting spring return AC: Adjustable cushion type												



RAS 25 - 50



RJS 25 - 50-25

Internal Structure

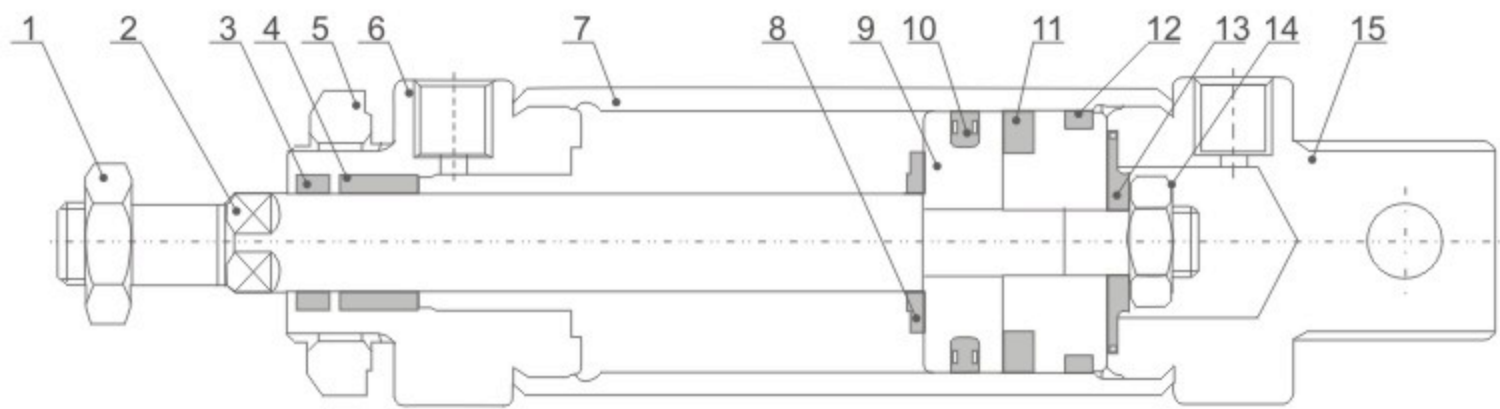

NO	Designation	NO	Designation
1	Piston Rod Nut	2	Piston Rod
3	Front Cover Seal Ring	4	Oiled Bearing
5	Front Cover Nut	6	Front Cover
7	Stainless steel tube	8	Anti-crash cushion
9	Piston	10	Piston O-Ring
11	Magnet(Optional)	12	Wear ring
13	Back cushion	14	Hex socket screw
15	Back Cover		

Specification

Bore(mm)	16	20	25	32	40
Motion pattern	Double Action				
Working Medium	Air				
Fixed Type	RLB RFA RSDB				
Operating Pressure Range	1-9.0MPa				
Ensured Pressure Resistance	13.5MPa				
Operating Temperature Range	-5~70℃				
Operating Speed Range	50~800mm/s				
Buffer Type	Standard Type	Anti-Bump Cushion			
	Damping Type	Adjustable Cushion			
Port Size	M5×0.8	G1/8"	G1/8"	G1/8"	G1/8"

Stroke

Bore(mm)	Standard Stroke																Max.Stroke	Permissible Stroke
16	25	50	75	80	100	125	160	175	200	300	500							
20	25	50	75	80	100	125	160	175	200	250	300	500	650					
25	25	50	75	80	100	125	160	175	200	250	300	350	400	450	500	500	650	
32	25	50	75	80	100	125	160	175	200	250	300	350	400	450	500	500	650	
40	25	50	75	80	100	125	160	175	200	250	300	350	400	450	500	500	650	



RAS Series Stainless Steel Mini Cylinder

Overall Dimensions

RAS

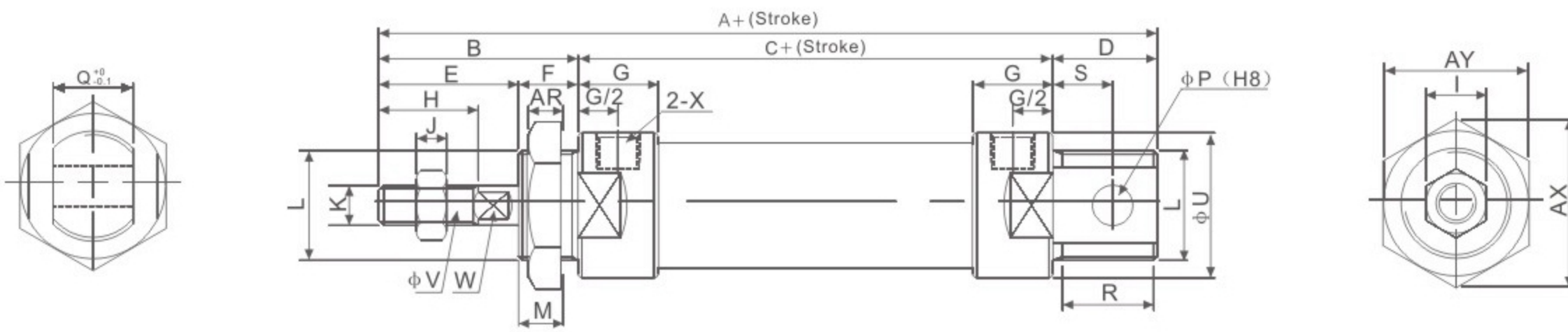

RAS-CM

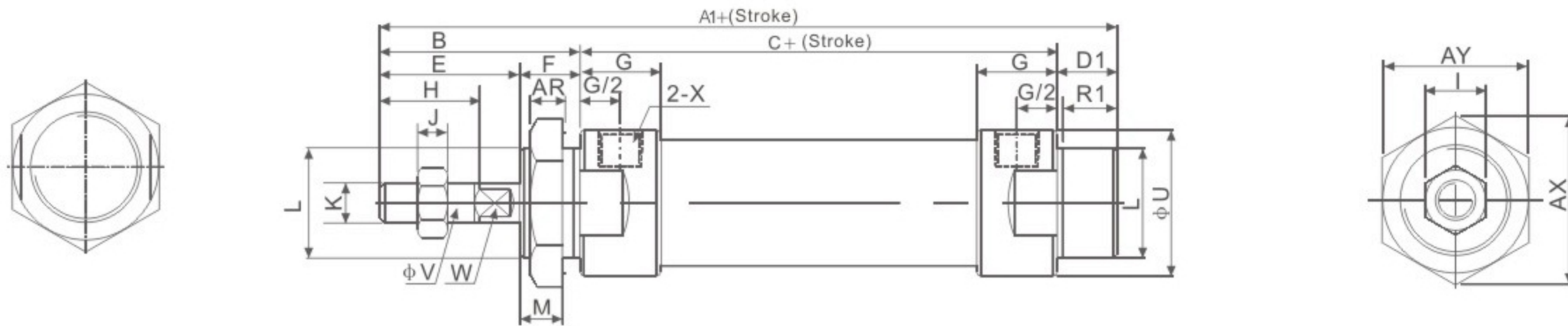

RAS-U

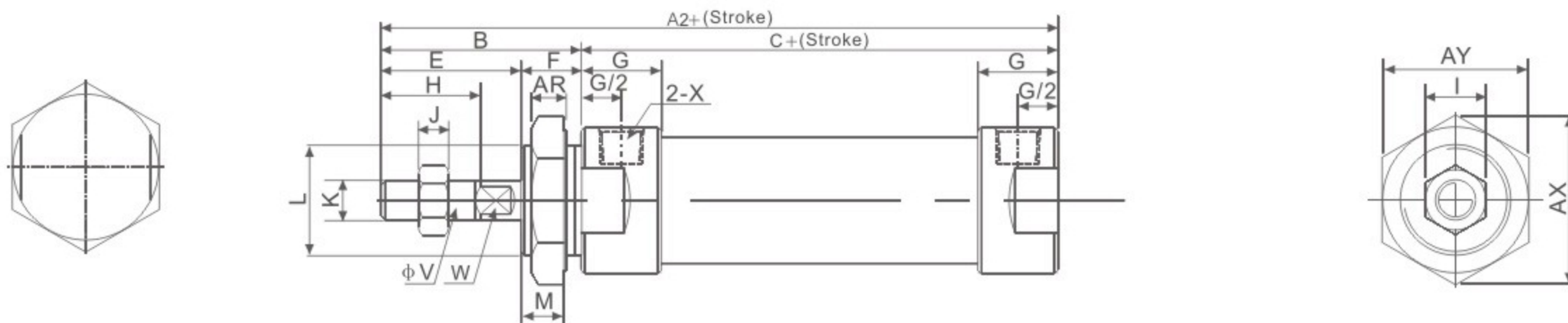

Dimension Sheet

Bore/Symbol	A	A1	A2	B	C	D	D1	E	F	G	H	I	J	K
16	114	114	98	38	60	16	16	22	16	10	16	10	5	M6×1
20	137	128	116	40	76	21	12	28	12	16	20	12	6	M8×1.25
25	141	134	120	44	76	21	14	30	14	16	22	17	6	M10×1.25
32	147	134	120	44	76	27	14	30	14	16	22	17	6	M10×1.25
40	149	136	122	46	76	27	14	32	14	16.7	24	17	7	M12×1.25

Bore/Symbol	L	M	P	Q	R	R1	S	U	V	W	X	AR	AX	AY
16	M16×1.5	14	6	12	14	14	9	21	6	5	M5	6	27.5	24
20	M22×1.5	10	8	16	19	10	12	27	8	6	G1/8"	7	33	29
25	M22×1.5	12	8	16	19	12	12	30	10	8	G1/8"	7	33	29
32	M24×2.0	12	10	16	25	12	15	35	12	10	G1/8"	8	37	32
40	M30×2.0	12	12	20	25	12	15	41.6	16	14	G1/8"	9	47	41



RAS Series Stainless Steel Mini Cylinder

Overall Dimensions

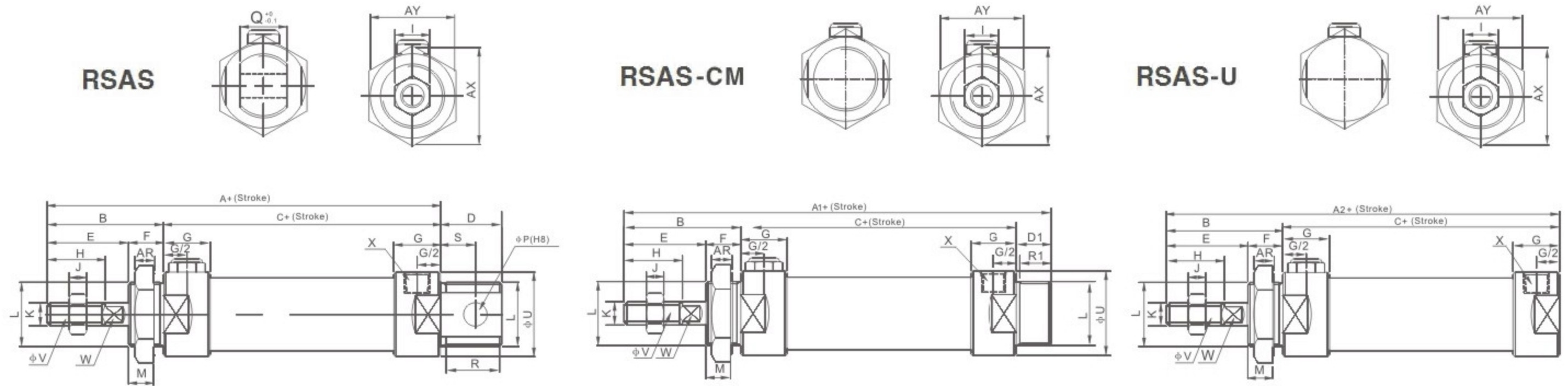

Dimension Sheet

Symbol Bore/Stroke	A		A1		A2		B	C		D	D1	E	F	G	H	I	J
	0-50	51-100	0-50	51-100	0-50	51-100		0-50	51-100								
16	114	139	128	153	98	123	38	60	85	16	16	22	16	10	16	10	5
20	137	162	134	159	116	141	40	76	101	21	12	28	12	16	20	12	6
25	141	166	134	159	120	145	44	76	101	21	14	30	14	16	22	17	6
32	147	172	136	161	120	145	44	76	101	27	14	30	14	16	22	17	6
40	149	174	122	144	122	147	46	76	101	27	14	32	14	16.7	24	17	7
Inside Diameter/Symbol	K		L		M	P	Q	R	R1	S	U	V	W	X	AR	AX	AY
16	M6×1		M16×1.5		14	6	12	14	14	9	21	6	5	M5	6	25	22
20	M8×1.25		M22×1.5		10	8	16	19	10	12	27	8	6	G1/8"	7	33	29
25	M10×1.25		M22×1.5		12	8	16	19	12	12	30	10	8	G1/8"	7	33	29
32	M10×1.25		M24×2.0		12	10	16	25	12	15	35	12	10	G1/8"	8	37	32
40	M12×1.25		M30×2.0		12	12	20	25	12	15	41.6	16	14	G1/8"	9	47	41

Overall Dimensions

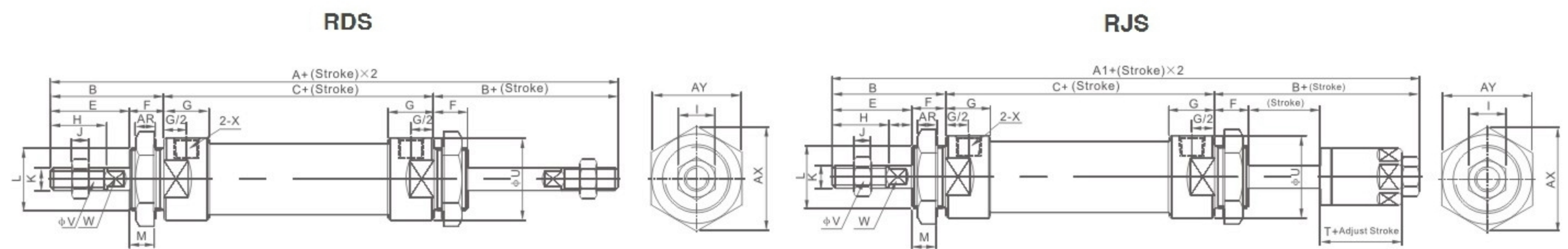

Dimension Sheet

Inside Diameter/Symbol	A	A1	B	C	E	F	G	H	I	J	K
16	136	135	38	60	22	16	10	16	10	5	M6×1
20	156	153	40	76	28	12	16	20	12	6	M8×1.25
25	164	161	44	76	30	14	16	22	17	6	M10×1.25
32	164	161	44	76	30	14	16	22	17	6	M10×1.25
40	168	164	46	76	32	14	16.7	24	17	7	M12×1.25
Inside Diameter/Symbol	L	M	U	V	W	X	AR	AX	AY	T	
16	M16×1.5	14	21	6	5	M5	6	25	22	16	
20	M22×1.5	10	29	9	6	G1/8"	7	33	29	19	
25	M22×1.5	12	34	10	8	G1/8"	7	33	29	21	
32	M24×1.5	12	39.5	12	10	G1/8"	8	37	32	21	
40	M30×2.0	12	41.6	16	12	G1/8"	9	47	41	21	